

UPS 15-58FC/FRC SUPERBRUTE

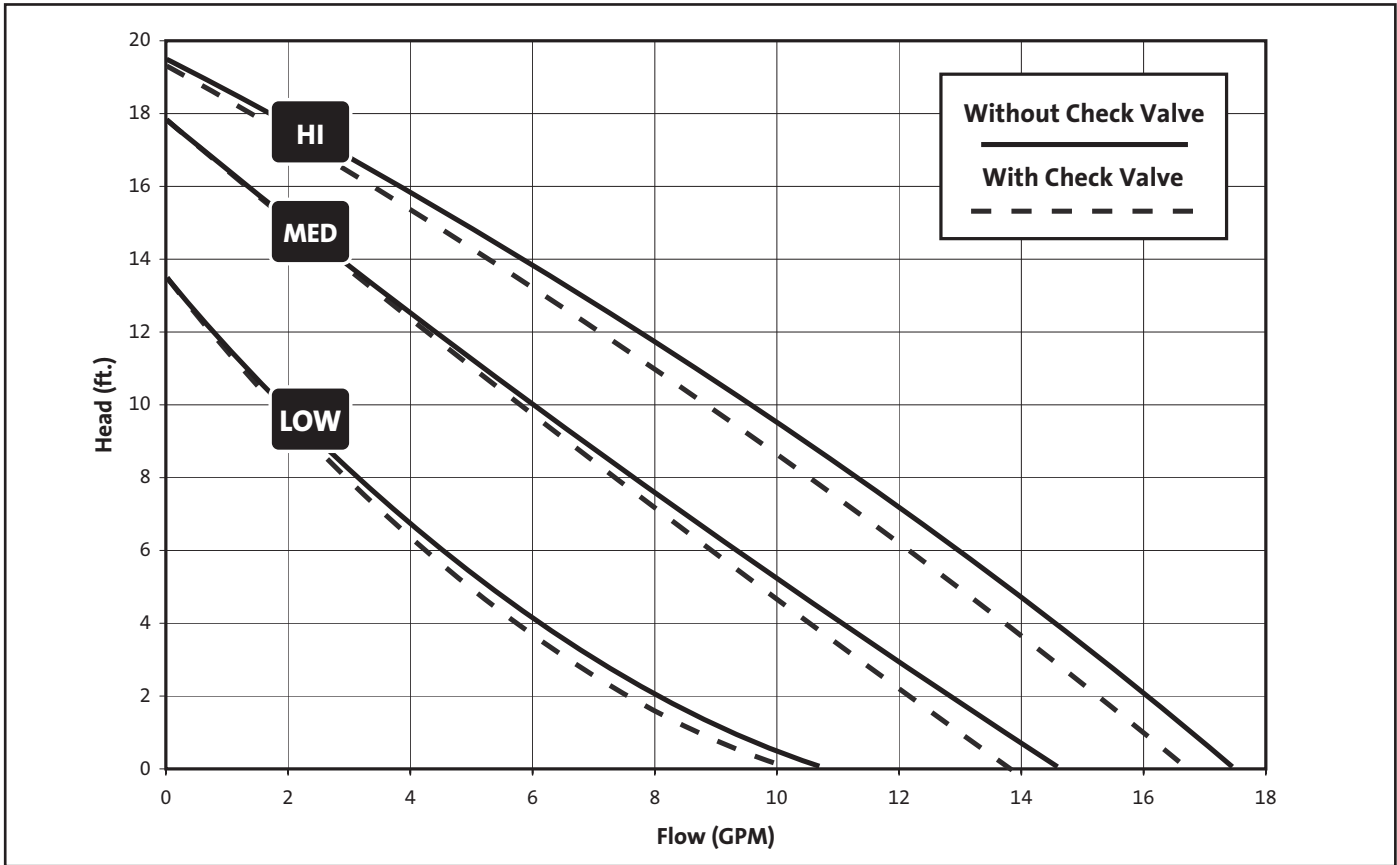

Flow range: 0 - 17.5 U.S. GPM  
 Head range: 0 - 19 FEET  
 Motors: 2 Pole, Single Phase  
 Maximum fluid temperature: 230°F (110°C)  
 Min. fluid temperature: 36°F (2°C)  
 Maximum working pressure: 145 PSI

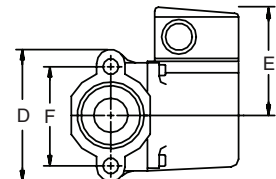
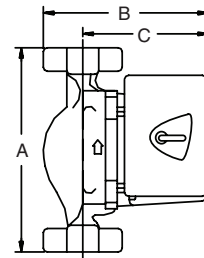

UPS15-58FC/FRC		AMPS	WATTS	HP	CAPACITOR
115V	Spd. 3	0.75	87	1/25	10mF/180V
	Spd. 2	0.66	80	1/25	10mF/180V
	Spd. 1	0.55	60	1/25	10mF/180V

Model Type	A	B	C	D	E	F	Connection Type and Size	Shipping Wt. (Lbs.)
UPS15-58FC/FRC	6 1/2	5 1/4	4	4 3/16	3	3 5/32	GF 15/26 Flange - (2) 1/2" Dia. Bolt Holes	7 1/4

**UPS 26-99FC/BFC SUPERBRUTE**

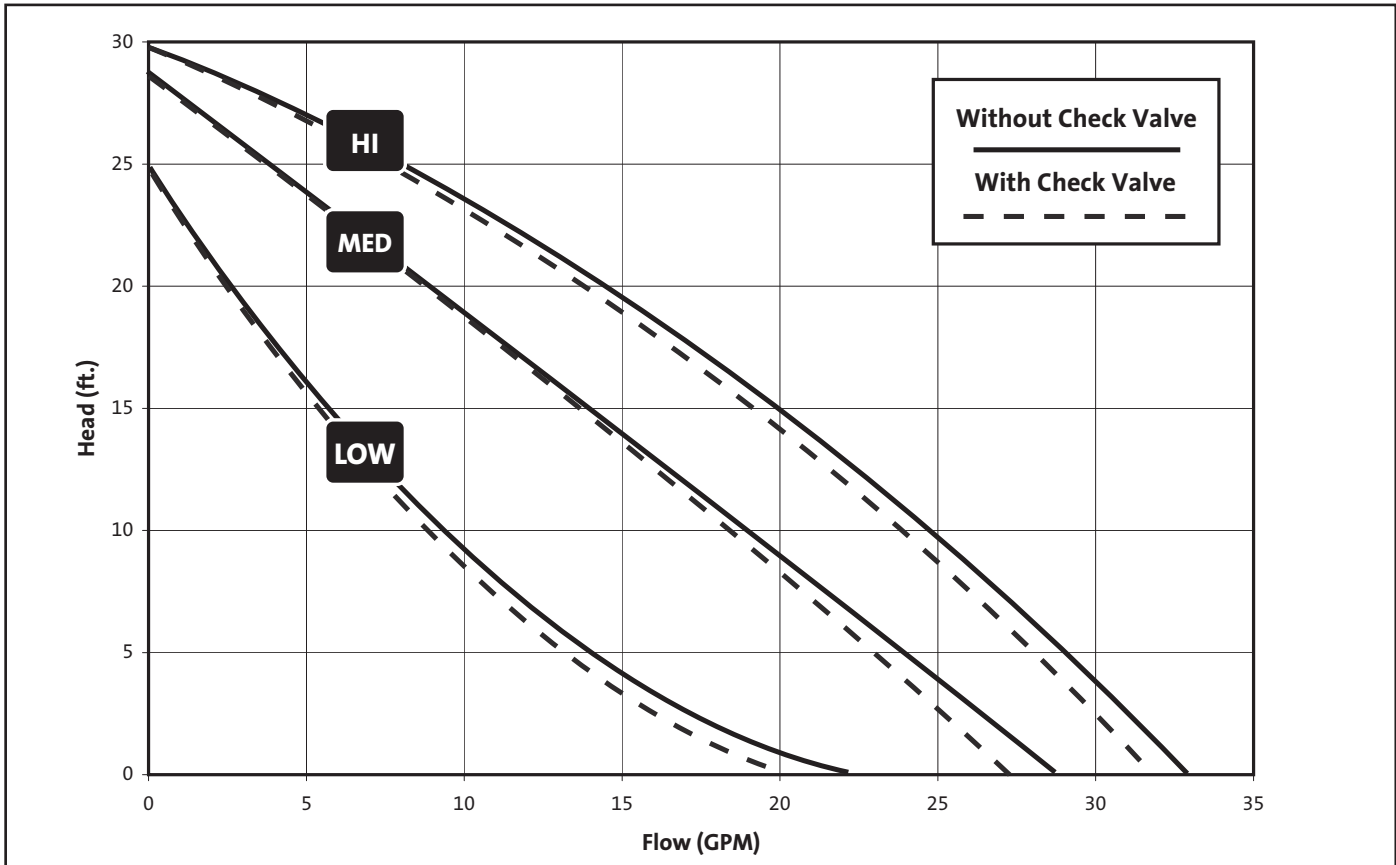

Flow range: 0 - 34 U.S. GPM  
 Head range: 0 - 30 FEET  
 Motors: 2 Pole, Single Phase  
 Maximum fluid temperature: 230°F (110°C)  
 Min. fluid temperature: 36°F (2°C)  
 Maximum working pressure: 145 PSI

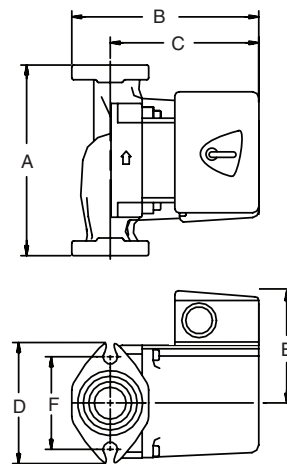

MODEL	VOLTS	AMPS	WATTS	HP	CAPACITOR
115V	Spd. 3	1.8	197	1/6	20mF/180V
	Spd. 2	1.5	179	1/6	20mF/180V
	Spd. 1	1.3	150	1/6	20mF/180V
230V	Spd. 3	0.9	196	1/6	5mF/400V
	Spd. 2	0.8	179	1/6	5mF/400V
	Spd. 1	0.7	150	1/6	5mF/400V

Model Type	A	B	C	D	E	F	Connection Type and Size	Approximate Shipping Wt. (lbs)
UPS26-99FC/BFC	6 1/2	6	4 7/8	3 1/2	3 7/16	3 5/32	GF 15/26 Flange - (2) 1/2" Dia. Bolt Holes	10.3

**UPS 43-44FC/BFC SUPERBRUTE**

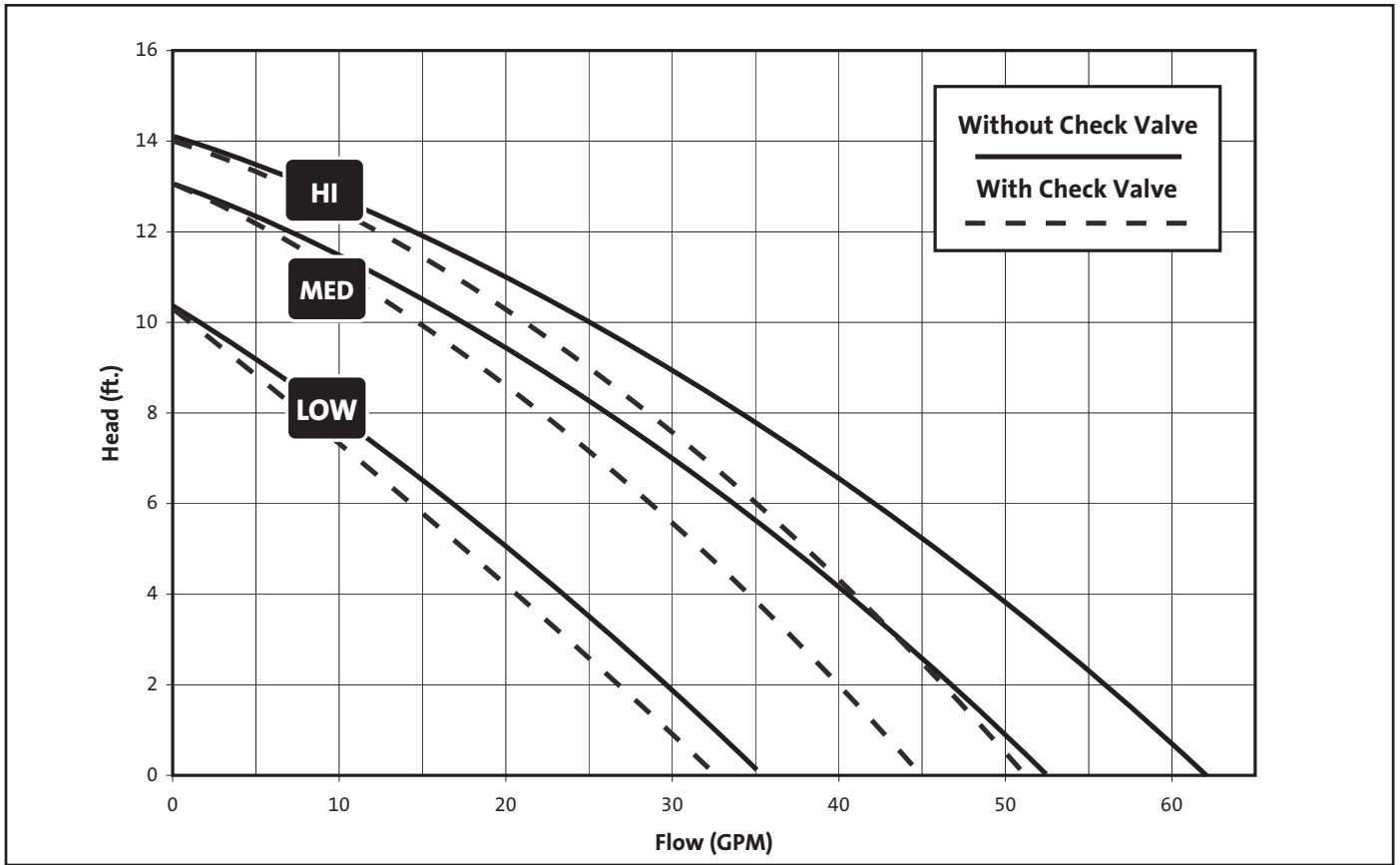

Flow range: 0 - 64 U.S. GPM  
 Head range: 0 - 14 FEET  
 Motors: 2 Pole, Single Phase  
 Maximum fluid temperature: 230°F (110°C)  
 Min. fluid temperature: 32°F (0°C)  
 Maximum working pressure: 145 PSI

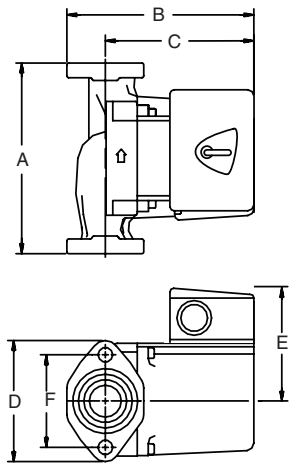

UPS43-44BFC/BFC		AMPS	WATTS	HP	CAPACITOR
115V	Spd. 3	1.8	203	1/6	20mF/180V
	Spd. 2	1.7	189	1/6	20mF/180V
	Spd. 1	1.4	157	1/6	20mF/180V
230V	Spd. 3	0.9	203	1/6	5mF/400V
	Spd. 2	0.8	190	1/6	5mF/400V
	Spd. 1	0.7	157	1/6	5mF/400V

Model Type	A	B	C	D	E	F	Connection Type and Size	Approximate Shipping Wt. (lbs)
UPS43-44FC/BFC	8 1/2	6 11/16	5 1/8	4 3/4	3 3/16	3 7/16	GF 40/43 Flange - (2) 1/2" Dia. Bolt Holes	13.6