

*Select Radiators  
Installation Guide*



<b>Informational Symbols.....</b>	<b>3</b>
<b>Before You Begin.....</b>	<b>4</b>
<b>Select Rough-In.....</b>	<b>5</b>
<b>Connection Installation.....</b>	<b>6</b>
<b>Optional Piping Arrangements .....</b>	<b>7</b>
<b>Conventional Wall Installation.....</b>	<b>8</b>
<b>Concrete Wall Installation.....</b>	<b>9</b>
<b>Select Mounting Bracket Locations .....</b>	<b>9</b>
<b>Valve Installation .....</b>	<b>10</b>
<b>System Start-Up/ Maintenance &amp; Cleaning .....</b>	<b>11</b>

## MYSON Warranty

MYSON warrants your Radiator for a Full Five Years against the following manufacturing defects:

1. MYSON warrants the plated or painted finish of your Radiator to be free of manufacturing defects for five years from the date of installation. This means your Radiator finish will not crack, split, peel or flake from the surface of the rails.
2. MYSON warrants the brazed connections and the tubing of your Radiator to be free from leaks for five full years from the date of installation.

For complete Warranty information, please contact Myson at 1-800-698-9690.

MYSON will repair or replace at our discretion any product which fails under these categories. We do not accept liability for any labor cost involved.

Should a problem occur, please do not hesitate to contact us.

We wish you years of satisfaction and comfort from your MYSON Radiator.

**NOTE: You will see these symbols within the text of this manual, drawing your attention to important information.**



Myson products are designed to be installed by professional trades people. Myson instructions are meant to be thorough; however it is assumed that the installer has the appropriate technical knowledge related to building codes, standard trade practices, and proper use of the tools of the trade. Should a homeowner without such knowledge or skill take it upon him/herself to attempt the installation, Myson will not be responsible for any damages, injuries or unsatisfactory performance of the Myson product used.



Information following this symbol indicates that it is important for the correct installation or use of the product. Failure to heed this information may affect the performance or useful life of the product. Risk of property damage or personal injury is low.



Information following this symbol must be followed without exception. Failure to follow these directions could result in moderate property damage or the possibility of personal injury.



Information following this sign must be carefully followed without exception. Failure to do so could result in significant and extensive property damage or serious personal injury or death.

**INSPECT FOR DAMAGE**

**NOTE:** Inspect materials for concealed shipping damage. You only have 11 days to file a freight claim. If items are damaged or missing please call Myson at 1-800-698-9690.

**INSPECTION FOR COMPLETENESS**

**Un-pack the Select Radiator carefully to avoid damage or loss of parts.**

The Select Radiator should come with the following parts:

- 2- Concrete wall brackets
- 1- Stainless steel solid plug
- 4- Plastic inserts for noise suppression
- 1- Stainless steel air vent plug with key
- 2- Conventional wall framing brackets (Radiators over 62 inches long have 3 brackets.)

**INTRODUCTION**

The Myson Select Radiator will keep any room in comfort and style. We at Myson thank you for your purchase of the Select Radiator. Each radiator combines Myson's compact design and advanced steel construction with a durable baked epoxy/polyester enamel power coat finish. Myson's sleek styling and thorough testing provides attractiveness and dependability. Myson's goal is to assure the highest performance, quality, reliability and outstanding customer service.

**CAUTION**

- 1** Read this entire instruction manual thoroughly before beginning installation.
- 2** To ensure full efficiency of your Myson Select Steel Panel Radiator, please follow all the instructions carefully observing the caution notes for each step.
- 3** Failure to follow these instructions will invalidate the manufacturer's warranty.

**Application:**

Myson radiators are only for use in recirculating closed loop hydronic-heating systems. These radiators are not recommended for gravity systems. Myson Select Radiators are designed to work with a maximum working pressure of 78 PSI and no more than 212 degrees F water temperature.

**DO NOT USE STEAM IN THESE RADIATORS.**

**Design and layout conditions:**

Myson Select Radiators should only be used with a recirculation pump closed loop hydronic heating system. Please consult national and local codes for specific restrictions that may be imposed on your installation. Position your radiator away from your circulator pump to avoid either excess pressure that could force water out the air vent or excess suction that could draw air into the system. The preferred positioning for the Select radiator is below a window where it can minimize downdrafts from glazed areas.

Myson Radiators may be hot to the touch. Generally the surface temperature is at 10-12 degrees Fahrenheit below system water temperature. Care must be taken to consider room occupant's ability to sense or understand that radiators may be hot. Should radiator surface or system water temperature be an issue, please contact MYSON at 1-800-698-9690 for information on the MYSON LST radiators. LST-(Low Surface Temperature) Radiators can be a viable solution where temperatures are a safety concern.



Rough-ins given are for MYSON TRV & Control Valves only. Valve specifications vary by manufacturer. Myson will not be responsible for damage or repair of property for rough-in with non-Myson Valves. Prior to committing pipe work behind finish floor or wall materials, consult Myson for assistance at 1-800-698-9690.

Dimensions are in inches. All valves are by MYSON and are 1/2" thread engagement in a vertical pattern. For two LKD valves, use LKD and TRV dimensions.

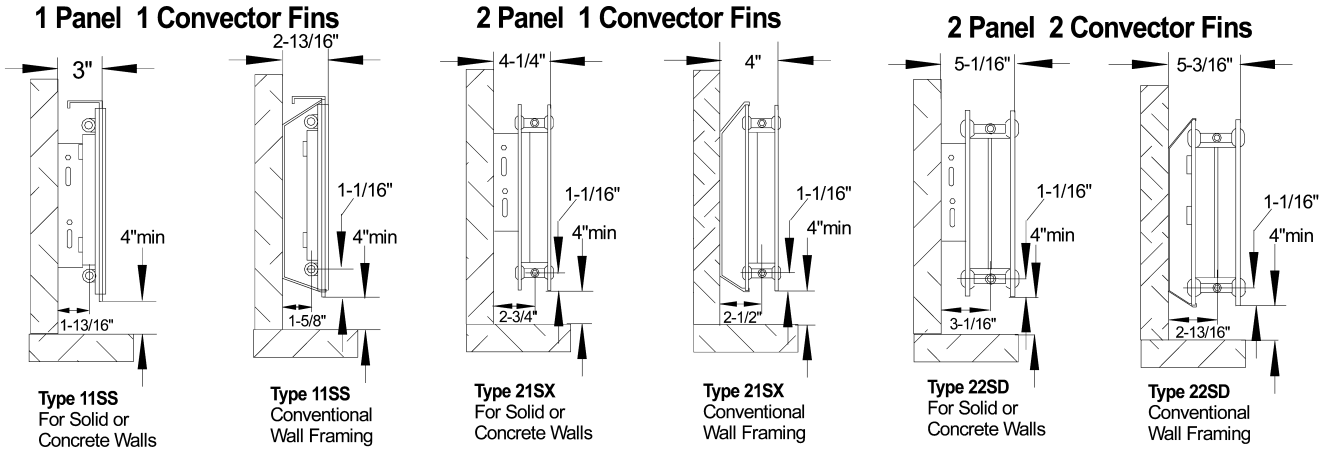

It is not recommended to route piping through the walls for single panel radiators (TYPE 11) as there is generally insufficient room to leave the wall and make the angle into the radiator.

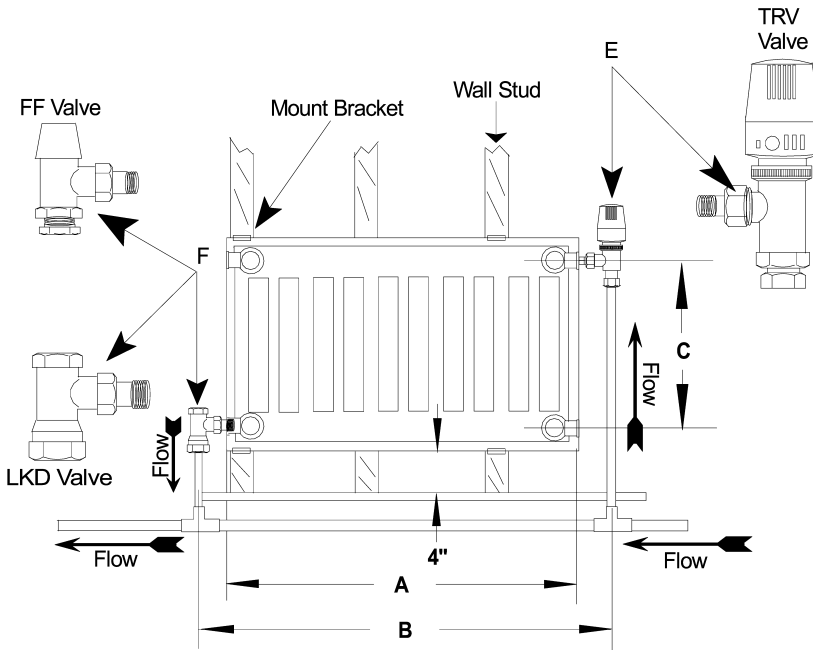

Nominal Height	Size	"C"
12	30	9-11/16"
16	40	13-5/8"
24	60	21-1/2"
28	70	25-7/16"

Model	Actual Length A	LKD & FF Valves B	LKD & TRV Valves C
40G	15-3/4"	19-3/8"	19-1/8"
50G	19-11/16"	23-5/16"	23-3/16"
60G	23-5/8"	27-1/4"	27-1/8"
70G	27-9/16"	31-3/16"	31-1/16"
80G	31-1/2"	35-1/8"	35"
90G	35-7/16"	39-1/16"	38-15/16"
100G	39-3/8"	43"	42-7/8"
110G	43-5/16"	46-15/16"	46-13/16"
120G	47-1/4"	50-7/8"	50-3/4"
130G	51-3/16"	54-13/16"	57-11/16"
140G	55-1/8"	58-3/4"	58-5/8"
160G	63"	66-5/8"	66-1/2"
180G	70-7/8"	74-1/2"	74-3/8"

### CONNECTIONS:

Myson Select Radiators come with four 1/2" connections located at the top and the bottom of both sides of the radiator.

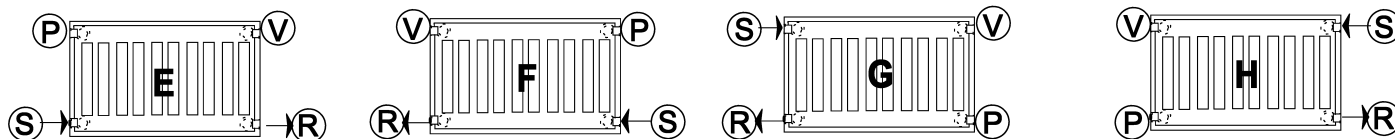
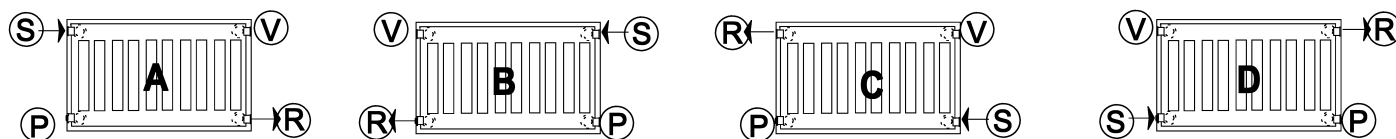
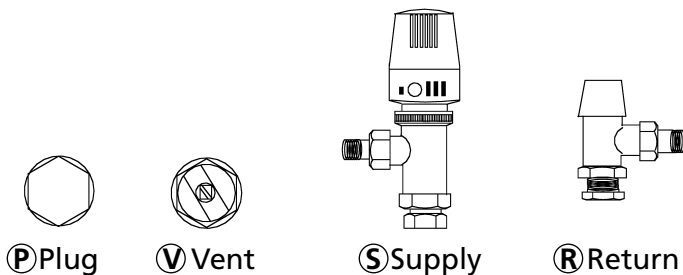

**P** All Myson Radiators are shipped with nylon paint plugs. All plugs must be removed and replaced by the appropriate plug, vent or valve. Failure to use Myson supplied plugs may result in significant water damage!

**P** The following drawings are general examples. Consult a certified heating professional for your specific application.

**i** For maximum comfort and control, MYSON recommends TRV valves on all layouts except the series loop system.

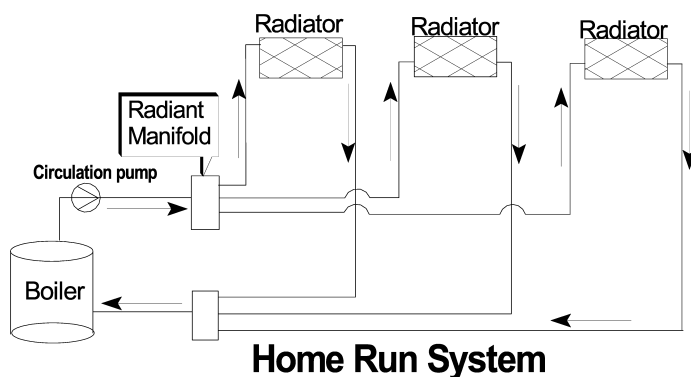
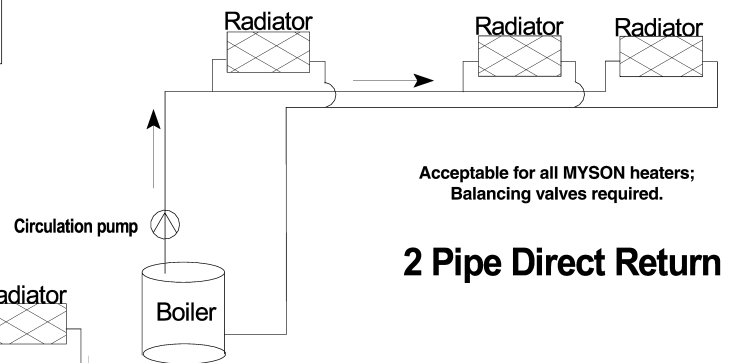
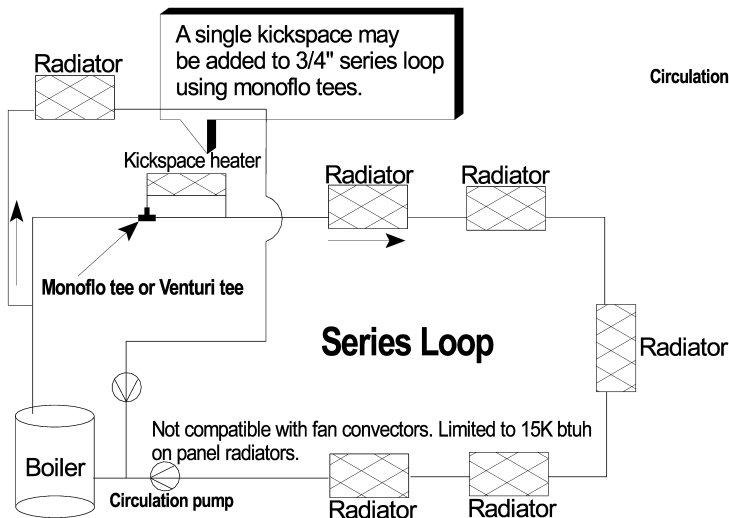
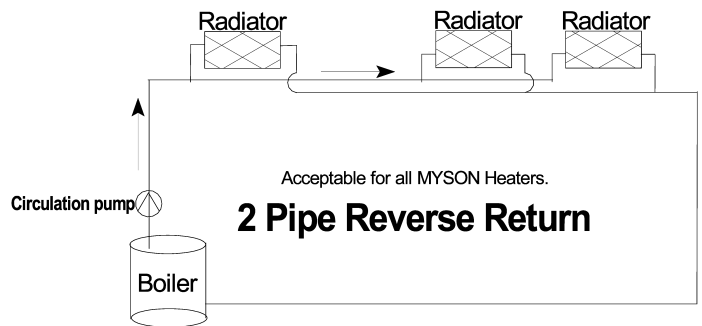
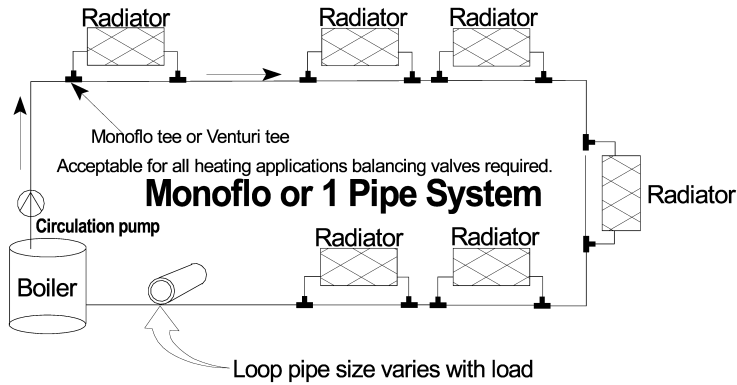

**Step 1** Locate studs in wall where the radiator is to be mounted.



**Step 2** Mount the brackets so the radiator is a minimum of 4 inches off the floor.

- Failure to allow 4" minimum clearance below radiator can significantly reduce radiator performance.
- Attach brackets firmly to the studs using appropriate hardware making sure the spring loaded connection on brackets is on top.
- All Select Radiators use 2 brackets except 160G and 180G use 3 brackets.
- Use a level to assure bracket is plumb.



**Step 3** Remove both side panels on the radiator.

- The side panels are held in place by plastic clips on each supply and return connection. Rotate plastic clips so opening is at bottom. To remove the side panel, hold side panels firmly on the top and bottom and lift.
- Side panels are cosmetic only. Removal will not reduce radiator performance.

**Step 4** Remove the top grill on the radiator by sliding it off.

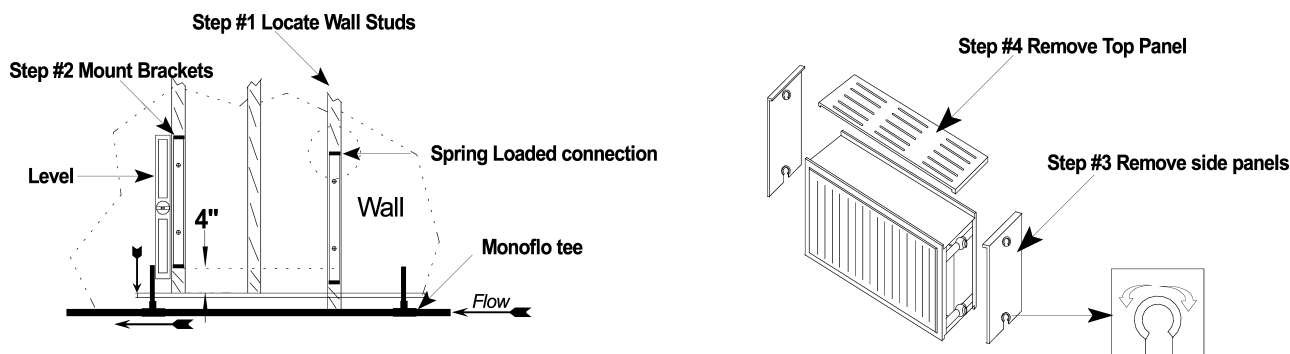

**Step 5** To install the radiator on the brackets, set the top edge of the rear panel into the upper part of the bracket then gently lift and snap the bottom into the lower part of the bracket.

**Step 6** Position radiator to line up with the supply and return pipes.

**Step 7** Assemble the radiator by putting the top and side panels back on the radiator.

Step # 5 Radiator mounting on bracket.

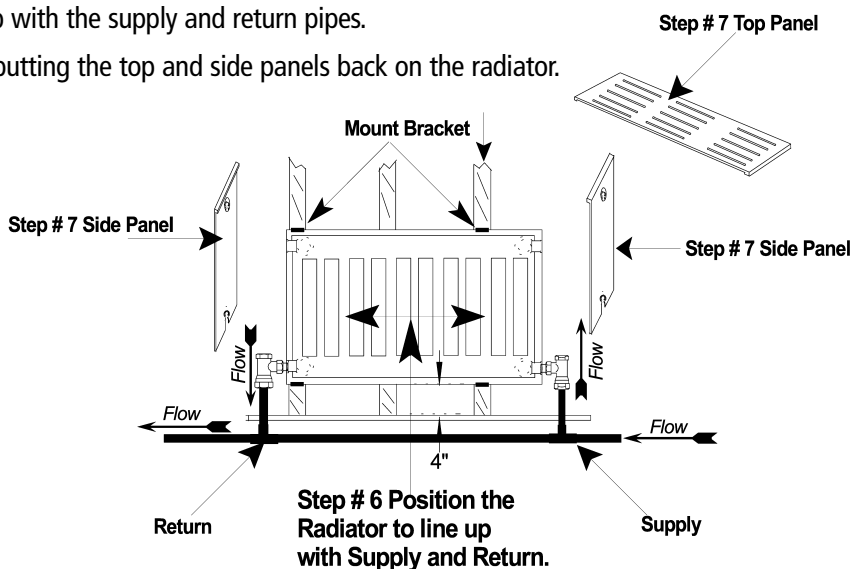
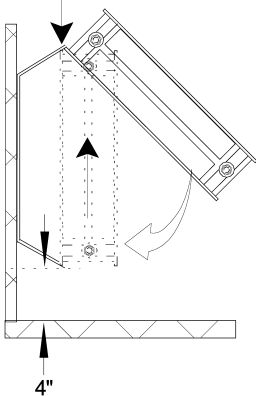

**Many MYSON products are in excess of 70 pounds. It is recommended to have help in lifting larger radiators to avoid lifting injuries. DO NOT lift a radiator by its top grill or side panels.**

**Step 1** Position radiator to line up with the supply and return pipes.

**Step 2** Position brackets on wall so that they line up with the centerline of the brackets on the rear of the Select Radiator.



**Step 3** Mount the brackets so the radiator is a minimum of 4 inches off the floor.

- Failure to maintain 4" minimum clearance to floor can significantly reduce radiator's performance.
- Attach brackets firmly to the wall using appropriate hardware.
- Use a level to assure bracket is plumb.



**Step 4** Place plastic inserts into the two slots on each bracket that will mount the radiator.

- Failure to use nylon inserts will increase the likelihood of expansion noise as radiator heats and cools. Many people find the noise annoying in an otherwise silent heating system.

**Step 5** Lift and seat the radiator onto the brackets.

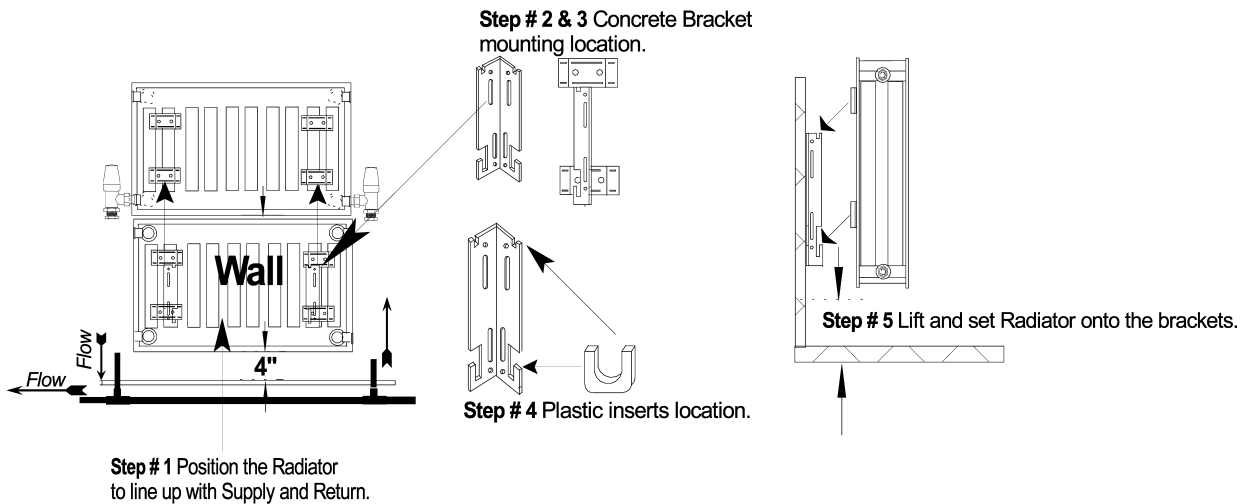

**Many Myson Radiators are in excess of 70 pounds. It is recommended to have help in lifting larger radiators to avoid lifting injuries. DO NOT lift a radiator by its top grill or side panels.**

## Select Mounting Bracket Locations

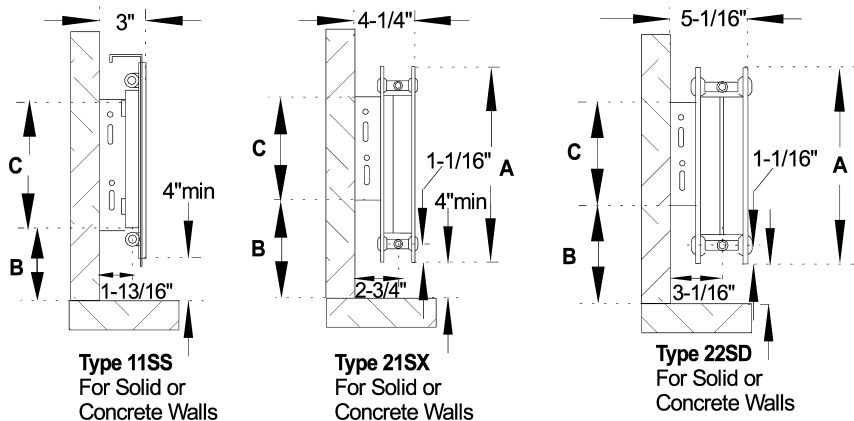

Nominal Height	A	B	C
12"	11-13/16"	6-1/4"	6-1/4"
16"	15-3/4"	8-3/16"	6-1/4"
24"	23-5/8"	9"	12-3/8"
28"	27-9/16"	10-15/16"	12-3/8"

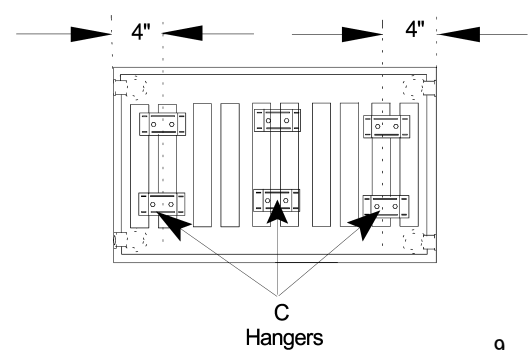



Nylon shipping plugs are meant solely for keeping paint from radiator threads during the painting process. Failure to remove plastic plugs and install the stainless metal plugs can result in significant property damage if heating system is run with plastic plugs in place.

**Step 1** Remove all plastic shipping plugs on the radiator.

**Step 2** Before proceeding clean tappings of any foreign material.

**Step 3** Install air vent plug.

**Step 4** Install blanking plugs.

**NOTE:** See page (5) for alternate valve and plug locations.



**Step 5** Apply teflon tape or compound to the threaded nipple on the valve.

**Step 6** Thread the nipple of the valve into the radiator using a 7/16 or 11mm Allen wrench.

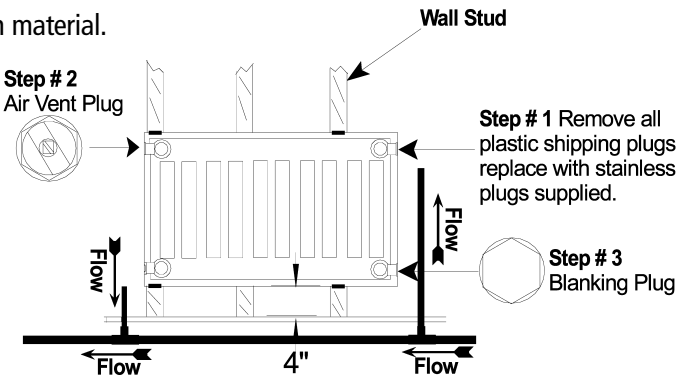

**CAUTION:** Do not over tighten and do not use a pipe wrench on ground joint.

**Step 7** Cut the copper pipe to a correct length.

**NOTE:** The pipe must fit all the way up to the stop in the valve body (approx 1" into the valve body).

**Step 8** Place compression nut on copper pipe.

**Step 9** Place compression ring on copper pipe.



**CAUTION:** DO NOT DAMAGE THE COMPRESSION RING.

**Step 10** Attach valve to valve nipple and tighten coupling. Turning valve body can damage compression ring.



**CAUTION: DO NOT** rotate valve body. Turn compression nut only and **DO NOT OVER TIGHTEN.**

**Step 11** Tighten compression nut.

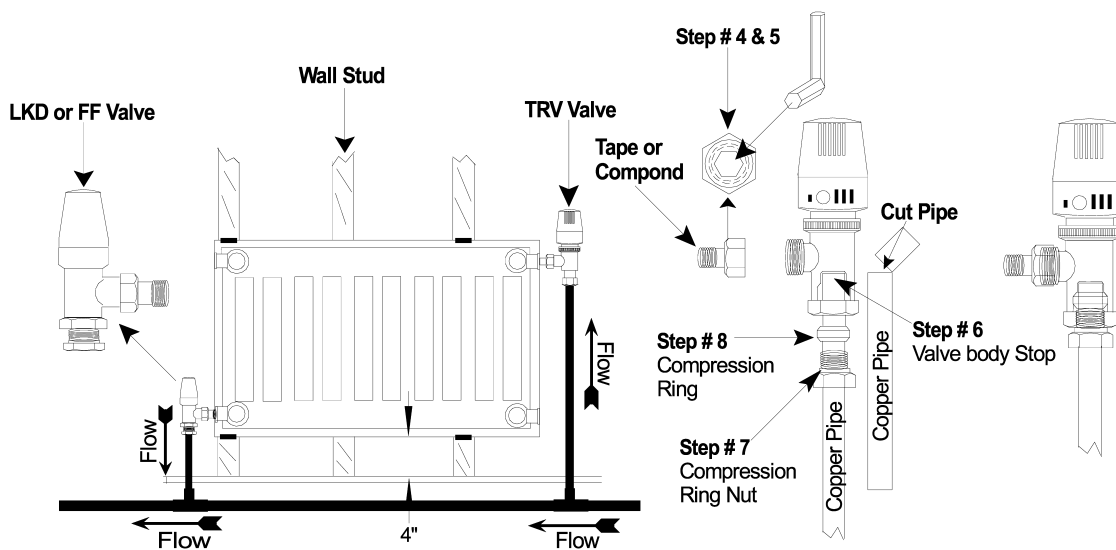

If glycol is to be added to the system for freezing protection, extra care must be taken to seal connections fully with teflon or pipe dope.



Failure to flush system of debris and flux may cause premature radiator failure, which can result in leaks and property damage NOT covered under the Myson Warranty.



#### SYSTEM START-UP:

- 1 Fill and vent the system.
- 2 Run the system for two (2) hours at full temperature with all radiator valves in the open position.
- 3 Shut off and drain the system while the water is still hot.
- 4 Refill and drain the system.
- 5 Reheat, vent, and balance the system.
- 6 Once the Select Radiator is filled with water the system should be left filled.
- 7 System should be checked for leaks on seasonal start-ups. Leaks must be repaired as automatic system fill valves allow fresh water/oxygen into the system attacking radiators internally.



#### MAINTENANCE & CLEANING:

- 1 Once operating, avoid the introduction of fresh water and oxygen to the system to prevent corrosion.
- 2 An occasional wiping with a damp cloth using a non abrasive detergent can protect the finish of your Myson Select Panel Radiator.
- 3 The use of abrasive cleaners will damage the surface of your radiator, and void the manufacturer's warranty.



#### ADDITIVES:

Treatment of the primary water is not usually required in a properly designed system.

Treatment may be necessary if either:

- 1 Local waters are known for their content of corrosive or if high bacterial levels are present.
- 2 If there is a possibility that the system may be idle during a prolonged period of freezing temperatures, system should be either drained or protected with antifreeze. If either corrosion inhibitors or anti-freeze is to be used, it should be added AFTER the system has been flushed in the final stages. Use only anti-freeze suitable for potable water.



Do not put heating system into operation without checking for leaks. Be sure the system is up to full operating temperature when conducting such a test. Leaks can appear in a heating system that were not noticeable if the test occurred with a cold system or when only tested with air pressure.



RADIATORS

**1-800-698-9690**

948 Hercules Drive  
Colchester, VT 05446

Fax: 802-654-7022

**[www.MysonInc.com](http://www.MysonInc.com)**

In accordance with our policy of continual product improvement,  
we reserve the right to amend specifications without prior notification