

  
**BRADFORD WHITE**<sup>®</sup>

**TTW2**

## Residential Through-The-Wall Energy Saver Gas Water Heater

### Features:



Bradford White is ISO registered to the 9001 standard.

- **Power vented for positive exhaust during main burner operation**—the TTW2 uses a specially designed assembly that blows exhaust gases directly out of the building, eliminating the need for conventional chimneys or expensive flue systems.
- **Hot surface ignition system**—Hot surface ignition eliminates the constant burning pilot used on other water heaters. This device results in savings of pilot gas during standby periods. (115V AC required to heater) Ignition system operates off of 24 volts.
- **3" PVC, ABS & CPVC (76mm) vent**—the water heater can be vented horizontally or vertically with 3" (76 mm) PVC, ABS & CPVC for lengths up to 30 feet (9.1 m) with (3) 90° elbows. (45 equivalent feet) (13.7 m).
- **4" PVC, ABS & CPVC (102mm) vent**—the water heater can be vented horizontally or vertically with 4" (102mm) PVC, ABS & CPVC for lengths up to 60 feet (18m) with (3) 90° elbows. (75 equivalent feet) (23m).
- **Vitraglas<sup>®</sup> lining**—Bradford White water heater tanks are protected from the corrosive effects of hot water by an exclusive ceramic porcelain-like coating. The Bradford White high silica Vitraglas<sup>®</sup> lining provides a tough interior surface for our hot water tanks.
- **Side connections**—for space heating.
- **Protective magnesium rod**—provides added protection against corrosion for long trouble-free service.
- **Factory installed Hydrojet<sup>®</sup> Total Performance System**—cold inlet sediment reducing device. Helps prevent sediment build up in tank. Increases first hour delivery of hot water while minimizing temperature build up at top of tank.
- **Factory installed dielectric waterway fittings**—all heaters equipped with special water heater nipples for longer life.
- **2" Non-CFC foam insulation (65 gallon model has 1" Non-CFC foam)**—covers the sides and top of tank to save energy by retarding loss of heat. Also increases jacket rigidity.
- **Fully automatic controls**—fast acting surface-mount thermostat for automatic temperature control. Built-in energy cut-off switch prevents abnormally high water temperature for extra safety. Combination gas valve/electronic module has built-in gas pressure regulation and electronic circuit controls. Ignition system operates off of 24 volts.
- **Brass drain valve.**
- **T&P relief valve included**—all sizes come standard with special tapping on side of tank.
- **Flue baffle**—designed to maximize the amount of heat absorbed in the lower portion of tank. Reduces air movement in the heater during standby periods to retard heat loss up the flue.
- **Six or ten year limited warranty on steel tank**—heavy gauge steel automatically formed, rolled and welded to assure a continuous seam for glass lining.
- **Six year limited warranty on parts.**
- **Design certified by CSA International (formerly AGA and CGA).**

MANUFACTURED UNDER ONE OR MORE OF THE FOLLOWING U.S. PATENTS:  
5,954,492; 5,761,379; 5,943,984; 5,081,696; 5,988,117; 6,142,216; 5,199,385;  
5,574,822; 5,372,185; 5,485,879; 5,277,171; (B1)5,341,770; 5,660,165; 5,596,952;  
5,682,666; 4,904,428; 5,023,031; 5,000,893; 4,669,448; 4,829,983; 4,808,356;  
5,115,767; 5,092,519; 5,052,346; 4,416,222; 4,628,184; 4,861,968; 4,672,919;  
Re. 34,534. OTHER U.S. AND FOREIGN PATENT APPLICATIONS PENDING.  
CURRENT CANADIAN PATENTS: 1,272,914; 1,280,043; 1,289,832; 2,045,862;  
2,112,515; 2,108,186; 2,107,012.



# Through-The-Wall Gas Water Heater

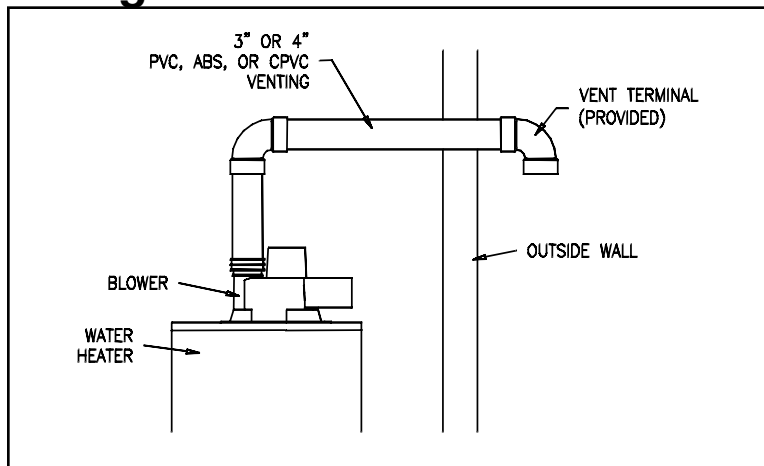
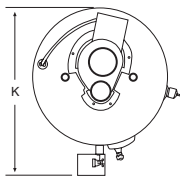
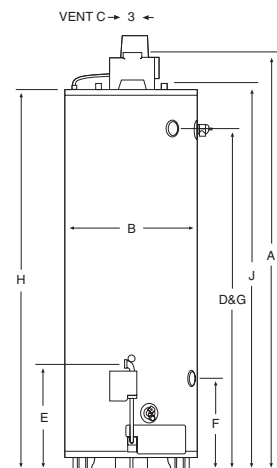

## Deluxe Energy Saver Models

Meet or exceed ASHRAE 90.1b (current standard) C.E.C. Listed 80% Recovery Efficiency

NATURAL GAS					Recovery 56°C Rise/ 90°F Rise**			A	B	C	D	E	F	G	H	J	K	Approx. Shipping Weight lbs. kg	
Model Number	Imp. Gal. Cap.	U.S. Gal. Liters	BTU Input	KW BTU	Imp. GPH	U.S. GPH	Liters/ Hr	Floor to Flue Conn. in. mm	Jacket Dia. in. mm	Vent Size in. mm	Floor to T&P Conn. in. mm	Floor to Gas Conn. in. mm	Fl. to Space Heating Return in. mm	Fl. to Space Heating Outlet in. mm	Fl. to Heater Top in. mm	Fl. to Water Conn. in. mm	in. mm		
M-II-TW-50T6BN <sup>(LP)</sup>	40	48	182	65,000	19.1	58	70	265	63¼ 1607	22 559	3 76	51 1295	16½ 419	14½ 368	51 1295	57¼ 1454	58 1473	26¾ 676	188 85
M-II-TW-65T6BN	54	65	246	65,000	19.1	58	70	265	66¾ 1695	22 559	3 76	54¾ 1384	16½ 419	14½ 368	54¾ 1384	60¾ 1543	61¾ 1562	26¾ 676	222 101
M-II-TW-75T6BN <sup>(LP)</sup>	62	75	284	76,000	22.3	67	82	310	66 1676	26 660	3 76	53 1346	18¾ 476	17¾ 451	53 1346	60 1524	60¾ 1543	30¾ 778	277 126

All propane heaters are equipped with a cast iron burner.  
To order a propane heater change suffix "BN" to "CX". For 10 year models, change suffix from "6" to "10".  
\*Based on manufacturers rated recovery efficiency.

110 V.A.C. Required for Power Venting

110 V.A.C. 60HRZ 2.1 Amperes

### MAXIMUM HORIZONTAL AND VERTICAL VENT

3" PVC, ABS & CPVC (76mm)† 4" PVC ABS & CPVC (102mm)†  
30 ft. (9.1 m) 60 ft. (18 m)

(3) 90° elbows

† Note: For high altitude installation, consult installation instructions

All natural gas models meet SCAQMD Requirements.

Meets NAECA Requirements

### General

All gas water heaters are certified at 300 PSI test pressure (2068 kPa) and 150 PSI working pressure (1034 kPa). All water connections are ¾" NPT (19mm) on 11" (279mm) centers, all gas connections ½" (13mm). All models design certified by CSA International (formerly AGA/CGA) and peak performance rated.

**Dimensions and specifications subject to change without notice in accordance with our policy of continuous product improvement.**

### 6-Year Limited Warranty on Component Parts

BRADFORD WHITE CORPORATION has a 6-year warranty on replaceable parts – gas valve, thermostat, burner, dip tube, drain valve and blower assembly. These quality components are manufactured for us by industry leaders and will be replaced in the event of failure during the parts warranty period (exclusive of shipping and re-installation cost.)§

§ Some states do not allow limitations on warranties. For product installed in the USA, Canada and Puerto Rico. See complete copy of the warranty included with the heater.

### 6 or 10-Year Limited Tank Warranties

BRADFORD WHITE CORPORATION LIMITED WARRANTY: Protects your investment in a quality glass-lined heater. If the tank leaks for reasons of faulty materials, workmanship, or corrosion within the warranty period, the heater will be replaced with a comparable heater of our manufacture (exclusive of shipping and re-installation cost.)§

### <sup>(LP)</sup> Propane Gas Inputs

	Recovery at 50°C Rise and 90°F Rise				
	Imp GPH	US GPH	Liters/Hr		
M-II-TW50T6CX	18.5 KW	63,000 BTU/Hr	57	68	257
M-II-TW75T6CX	18.5 KW	73,000 BTU/Hr	66	79	299

### Suitable for Water (Potable) Heating and Space Heating

Toxic chemicals, such as those used for boiler treatment, shall NEVER be introduced into this system. This unit may NEVER be connected to any existing heating system or component(s) previously used with a non-potable water heating appliance.

**BRADFORD WHITE**<sup>®</sup>  
CORPORATION

Ambler, PA

Sales/800-538-2020  
800-532-4020  
Fax/215-641-1670

Service/800-334-3393  
Fax/269-795-1089

Warranty/800-531-2111  
Fax/269-795-1089

**International:**  
Telephone/215-641-9400  
Telefax/215-641-9750

**Fax on Demand:**  
888-538-7833

[www.bradfordwhite.com](http://www.bradfordwhite.com)

**BRADFORD WHITE-CANADA**<sup>™</sup> INC.  
Mississauga, ON

Sales/866-690-0961  
905-238-0100

Fax/905-238-0105

Service/800-334-3393

[www.bradfordwhitecanada.com](http://www.bradfordwhitecanada.com)